

*Embrace
the change...*

VA
VERSACCOM



*...Realise
the Concept*

Introduction

With over 20 years experience in the portable building industry, Versacom has combined the technology of the international transport industry with the latest technology of the building industry, producing an extremely versatile modular accommodation unit that can be added to or subtracted from to a room of any size for any purpose. By utilizing ISO transport designs, these units can be easily shipped to any destination in the world using standard road, rail and sea carriers.

Using one vehicle, Versacom can supply 8 units linked together to form a 20' x 64' room. The time taken to carry out this assembly is only 8 hours. You save on transport costs, manpower costs and are operational within 24 hours.

Throughout this brochure we will prove to you that you should you require instant accommodation for temporary or semi-permanent contracts, Versacom will satisfy your needs.

You will see from the use of the latest composite panel design produced by the UK's leading manufacturer that Versacom uses only the best materials available. Indeed should the contract require non-combustible materials we have 'off-the-shelf' fire-rated panels. So you see we can fulfil your wishes for your accommodation requirements.

The next few pages will give you comprehensive information providing all the necessary technical aspects of the manufacture of Versacom modular accommodation. Should you require further information or would rather view the units please contact us in order that we may satisfy your curiosity!

Tel: +61(0)7 3907 0283

Fax: +61(0)7 3907 0282

Email: info@versacom.com



VERSACCOM units are manufactured from only the finest materials available. Composite panels set into a structural steel frame provide the body of our units, the layout of which is fully integrated and interchangeable. No cutting or drilling of the units is required to give your customers exactly what they want. Standard panels are taken from stock and clipped together to suit your customers precise requirements.

Steel frame - Purpose designed cold rolled sections are fully welded to standard ISO blocks, shot blasted and painted to provide the units with a durable skeleton.

External Walls - Composite panels designed and manufactured by one of the UK's leading suppliers, are faced with Corus (British Steel) Colorcoat steel. The weather side is HPS200, offering superior durability and aesthetics with a 15 year Corus guarantee to resist failure due to the effects of natural weathering. The internal surface is Stelvetite, a brilliant white satin finish as used throughout the food industry for its durability,

cleanability and aesthetics. The core material is either Rockwool or expanded polystyrene (eps). Rockwool should be specified if fire is an issue and eps if not.

Internal walls - Composite panels, as above but with Stelvetite on both faces.

Ceilings/roof - Composite panels, as above but with a Stelvetite face internally and a single ply membrane water proof external covering.

Floor - External quality plywood faced as required.

Doors - Manufactured using the same composite panel technology, with satin anodised aluminium capping and frame, provide a secure and durable entrance to the units.

Windows - Matching satin anodised aluminium, double glazed units complete with thermal break, provide either fixed or opening lights with lockable handles.

Embrace the change... ...realise the concept

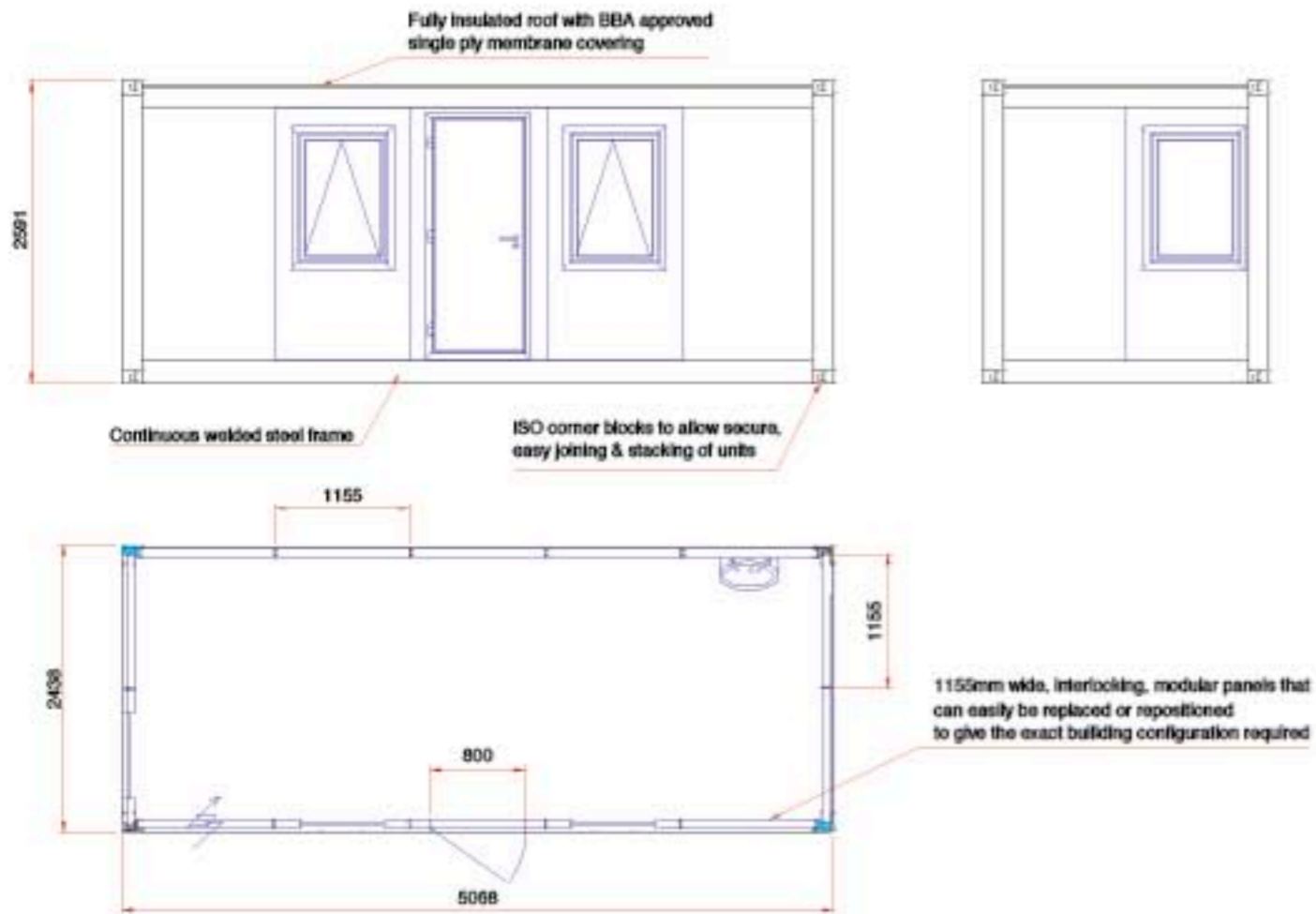

Typical details of a single Versacom Unit



Construction

New panels are easily installed into the ISO frame allowing speedy erection and/or alterations of the unit. No special skill other than care and diligence is required to undertake the work. Full training will be given.

For safety reasons it is recommended that a qualified electrician and plumber are used to carry out the service connections, this will also ensure that any local safety standards are met.

Health and safety at work must be considered at all times.

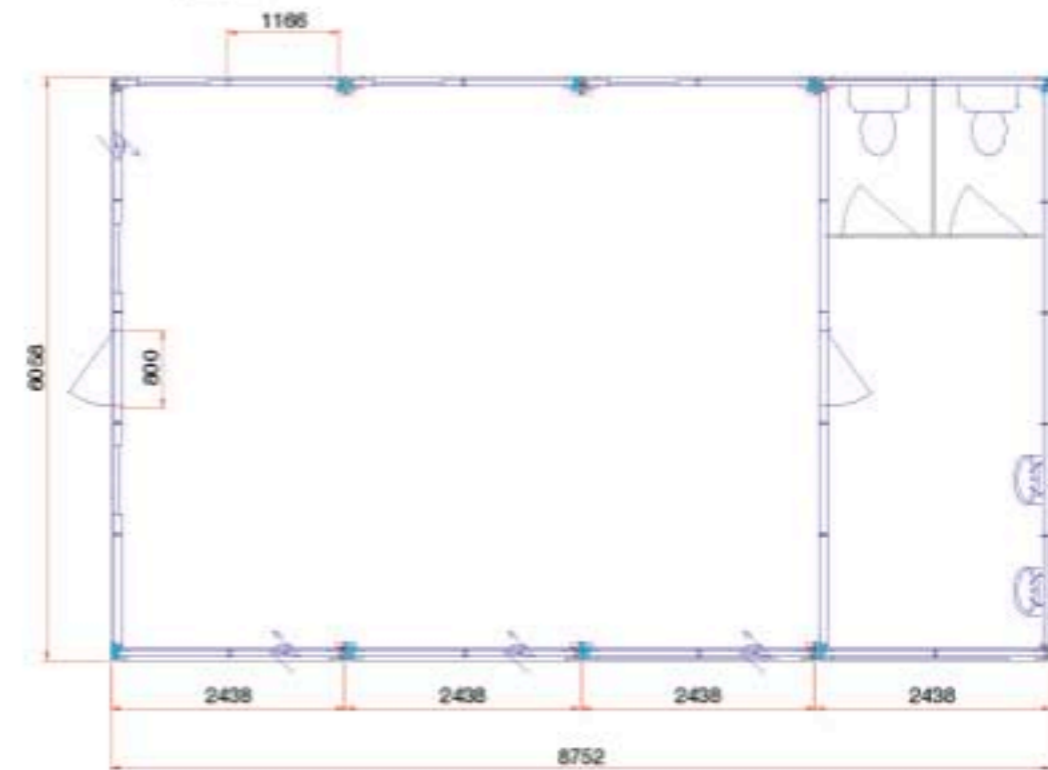
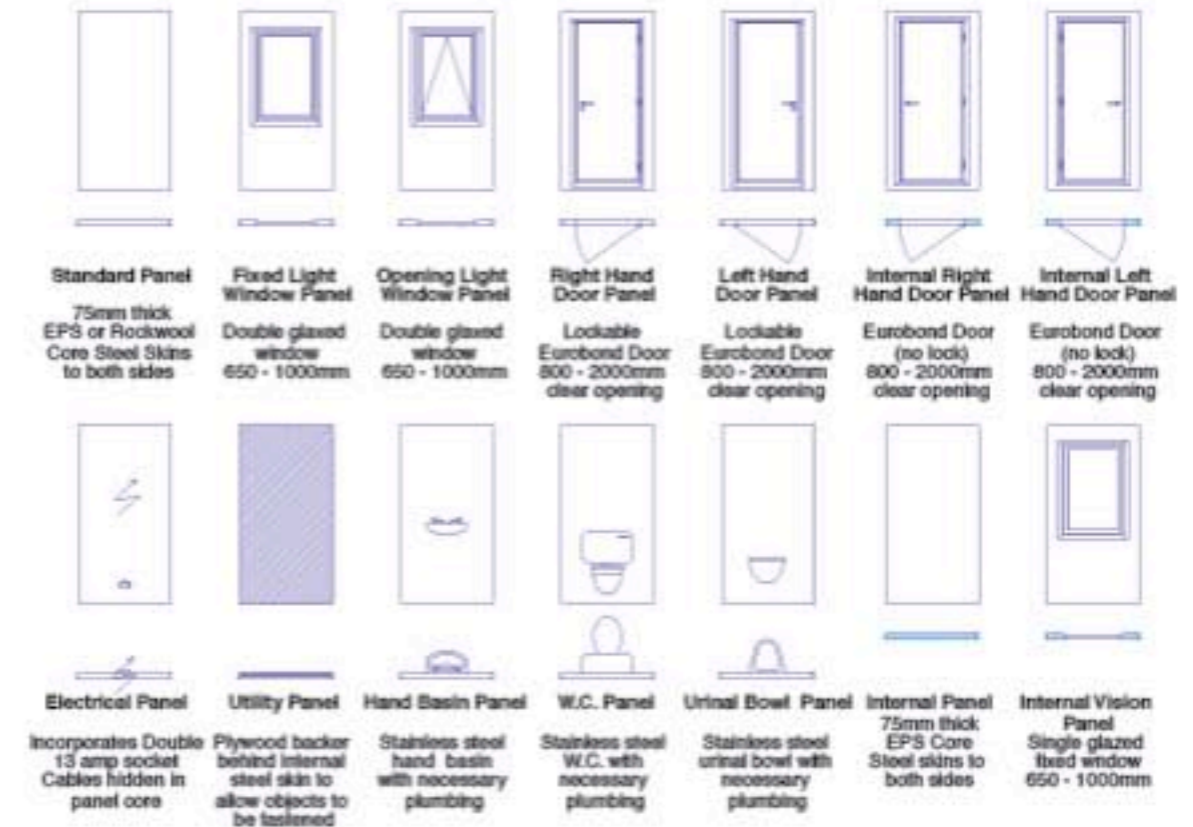

Typical layout of 4 combined Versacom Units

Give your customers what they want, not what you've got!



VA

VERSACCOM

VA
VERSACCOM

Tel: +61(0)7 3907 0283 • Fax: +61(0)7 3907 0282 • Email: info@versacom.com
www.versacom.com

VA

VERSACCOM



Modular Accommodation

